

CANDIDATE APPLICATION
2011 DREAM ROOM COMPETITION

Complete and Return to: The NEC Group, a Utah Corporation
2504 N. Ontario Street Burbank, CA 91504
Ph: 818.557.2950 Fax: 818.557.2966

Indicate Show

Date Today _____

<u>2011</u>	<input type="checkbox"/> January 7-9	South Towne Expo	Sandy, Utah
	<input type="checkbox"/> January 15-16	OC Fair & Event Center	Costa Mesa, CA
	<input type="checkbox"/> June 25-26	Los Angeles Convention Center	Los Angeles, California

Candidate Name _____

Company Name _____

Company Address _____

City _____ **State** _____ **Zip Code** _____

Phone Number _____ **Fax Number** _____

Email Address

ASID Member Yes No **Years of Experience** _____
Residential Designer Yes No

Please include a photo of your work of choice with your completed application.

The photo will not be returned to you.

Please pick desired room to design.

First, second, and third choice by numbering in space provided 1, 2, and 3.

<input type="checkbox"/> Kitchen	<input type="checkbox"/> Dining Room	<input type="checkbox"/> Children's room	<input type="checkbox"/> Nursery
<input type="checkbox"/> Family Room	<input type="checkbox"/> Game Room	<input type="checkbox"/> Living Room	
<input type="checkbox"/> Patio/Backyard Fun Area	<input type="checkbox"/> Master Bedroom	<input type="checkbox"/> Home Office	

Comments _____

Designers and vendors may provide signage and business cards for each room but are prohibited from personal solicitation at the design room site.

NOTE: Cancellations must be made 3 weeks prior to show date.
All cancellations after that date will incur the full booth price of \$2490.00.

Read and Agreed to by: _____ **Date:** _____

Questions: Please Contact the Show Coordinator
California: Kathy Sloan: 818.557.2950 Email: neckathy@yahoo.com
Utah: Vikki Prudden 801:571.9012 Email: productionnec@sisna.com

Interior Design Section Specifications Dream Room Competition

20 FEET

10 FEET

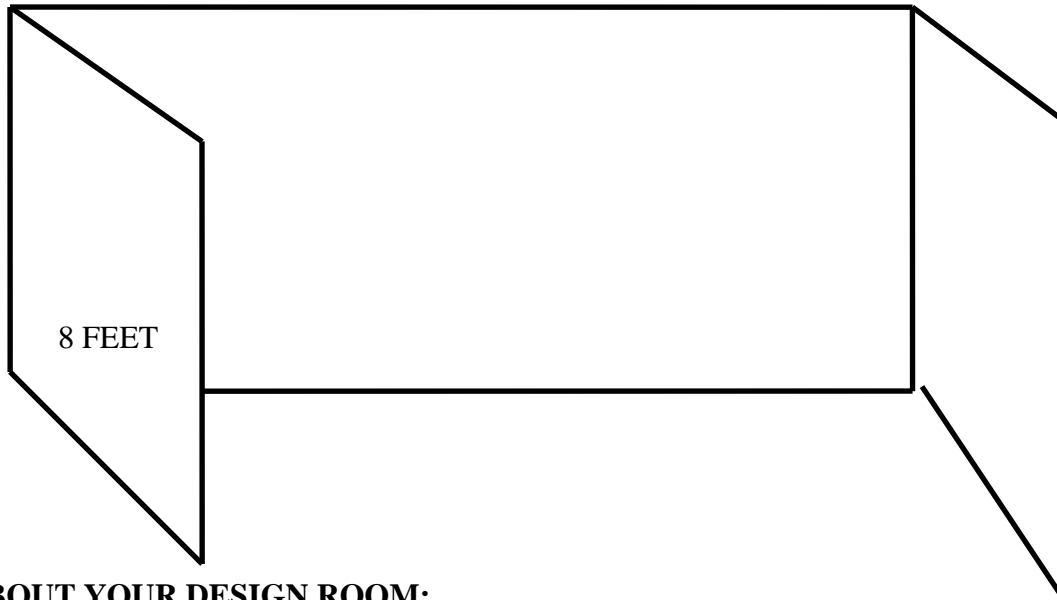

ABOUT YOUR DESIGN ROOM:

Designers and vendors may provide signage and business cards for each room but are prohibited from personal solicitation at the design room site.

Design Space: 20 feet long by 10 feet deep by 8 feet high.

Walls: Hard wall construction with a white surface.
Wall seams need mud.

Allowed: Wallpaper, nails, and picture hangers.

Not Allowed: No holes cut into the walls.

Floor: Concrete. You may put any kind of flooring down BEING CAREFUL

Allowed: Any flooring. **CAREFUL NOT TO DAMAGE THE CONCRETE.**

Safety: No one allowed entering the rooms during the show.

Stanchions placed in front of design rooms prohibit entry.

2 Weeks Prior to Show

PLEASE PROVIDE:

A) List of all suppliers for each room.

We will provide a sign of appreciation for each supplier.

B) Designer's Name

We will provide a sign designating the designer of the room.

DESIGN ROOM SET UP:

Days & Time to be announced.

MOVE OUT TIMES:

SUN. Close of show. 6:00 p.m.-9:00pm

MON. After show. 8:00 a.m. - 12:00 Noon

First Day of Show: 8:00 a.m. - 10:00 a.m Final Touches Only.

JUDGING: First morning of show: 10am