

**CANDIDATE APPLICATION
2010 DREAM ROOM COMPETITION**

Complete and Return to: The NEC Group, a Utah Corporation
2504 N. Ontario Street Burbank, CA 91504
Ph: 818.557.2950 Fx: 818.557.2966

Date Today _____

Indicate Show

___ January 8-10	South Towne Expo	Sandy, Utah
___ June 26-27	Los Angeles Convention Center	Los Angeles, California
___ August 21-22	OC Fair & Event Center	Costa Mesa, California

Candidate Name _____

Company Name _____

Company Address _____

City _____ **State** _____ **Zip Code** _____

Phone Number _____ **Fax Number** _____

Email Address

ASID Member **Yes** ___ **No** ___ **Years of Experience** _____

Residential Designer **Yes** ___ **No** ___

Please include a photo of your work of choice with your completed application.
The photo will not be returned to you.

Please pick desired room to design.

First, second, and third choice by numbering in space provided 1, 2, and 3.

___ Kitchen	___ Dining Room	___ Children's room	___ Nursery
___ Family Room	___ Game Room	___ Living Room	
___ Patio/Backyard Fun Area	___ Master Bedroom	___ Home Office	

Comments _____

Designers and vendors may provide signage and business cards for each room but are prohibited from personal solicitation at the design room site.

NOTE: Cancellations must be made 3 weeks prior to show date.
All cancellations after that date will incur the full booth price of \$2490.00.

Read and Agreed to by: _____ **Date:** _____

Questions: Please Contact the Show Coordinator

California: Kathy Sloan: 818.557.2950 Email: neckathy@yahoo.com

Utah: Vikki Prudden 801:571.9012 Email: productionnec@sisna.com

Complete and Return to: The NEC Group, a Utah Corporation
2504 N. Ontario Street Burbank, CA 91504
Ph: 818.557.2950 Fx: 818.557.2966

Interior Design Section Specifications 2010 Dream Room Competition

20 FEET

10 FEET

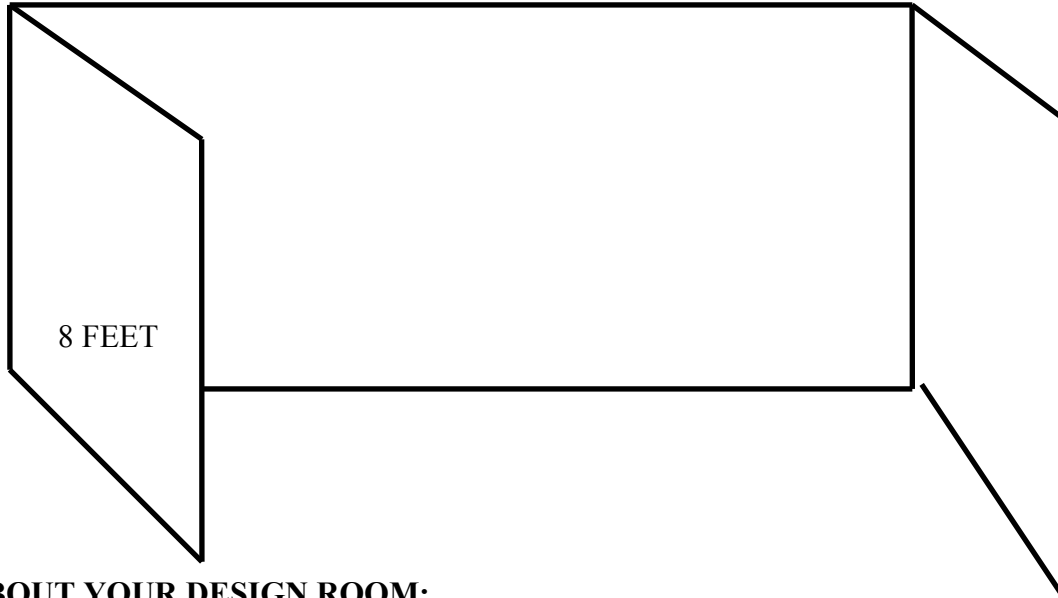

ABOUT YOUR DESIGN ROOM:

Designers and vendors may provide signage and business cards for each room but are prohibited from personal solicitation at the design room site.

Design Space: 20 feet long by 10 feet deep by 8 feet high.

Walls: Hard wall construction with a white surface.
Wall seams need mud.

Allowed: Wallpaper, nails, picture hangers.

Not Allowed: No holes cut into the walls.

Floor: Concrete. You may put any kind of flooring down BEING CAREFUL

Allowed: Any flooring. **CAREFUL NOT TO DAMAGE THE CONCRETE.**

Safety: No one allowed to enter the rooms during the show.

Stanchions placed in front of design rooms prohibit entry.

2 Weeks Prior to Show

PLEASE PROVIDE:

A) List of all suppliers for each room.

We will provide a sign of appreciation for each supplier.

B) Designer's Name

We will provide a sign designating the designer of the room.

DESIGN ROOM SET UP :

Days & Time to be Announced.

MOVE OUT TIMES:

SUN. Close of show. 6:00pm -9:00pm

MON. After show. 8:00 am - 12:00 Noon

First Day of Show: 8:00am. - 10:00am Final Touches Only.

JUDGING: First morning of show: 10am